

## HOW TO VERTICAL BLINDS

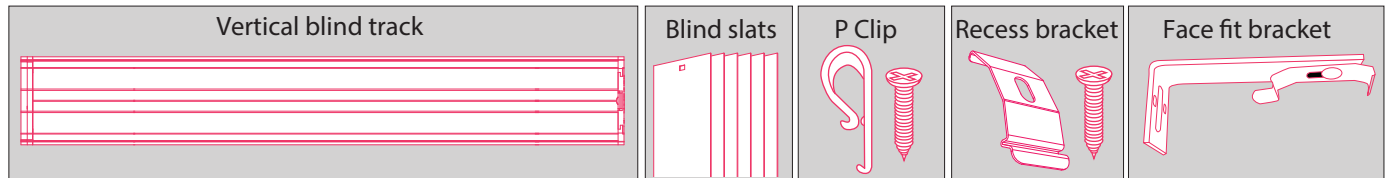

### Items Checklist

- Vertical blind track
- Blind slats
- 1 screws per bracket
- P Clips

### Tools Required

- Cordless Drill with Philips head drill bit
- Metal Tape Measure

Ensure brackets are mounted onto a firm surface such as a window frame. When mounting on alternative surfaces please see the table below as you will need to acquire special plugs or anchors.

PLASTER	TIMBER	CONCRETE, STONE, BRICK or TILE
We recommend the use of the Ramset 10mm Grip Hollow Wall Anchor	Pre-drill holes and use the included screws	Use a masonry drill and appropriate plugs, anchors or screws

### 1. Position and install the brackets

The amount of brackets supplied will vary depending on the width of the Vertical blind track.

#### a). Positioning your Vertical Blind - Recess Fit vs Face Fit

**RECESS FIT** - Inside your window frame

Position the end brackets at least 100mm's in from the end. Evenly space the middle brackets along the window frame.

**FACE FIT** - on the window frame or wall

Mark out the positions for the bracket at the desired even distance. If fitting the blind to architraves and the track has an overhang that goes past the window frame, put the end brackets level with the edge of the architrave.

**HANDY TIP:** For Face Fit, make sure to use the central screw hole on the bracket, this will then give you flexibility to be able to adjust the blind up and down easily to the desired height, without having to reposition the screw.

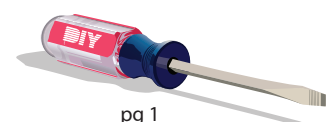
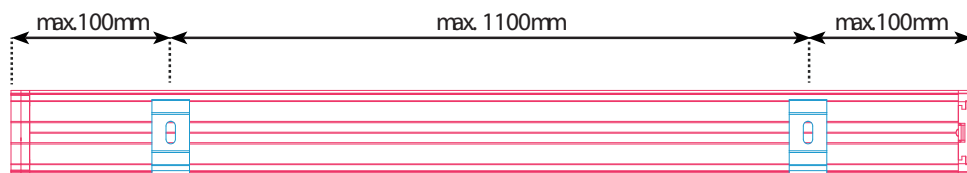

## VERTICAL BLINDS INSTALLATION

### 2. Hanging the Track

Take the vertical track with the central bracket, hook the front of the track into the forward lip of the bracket. Make sure the track is centre to the window and then click the track into place by rotating the back of the track up into the rear of the bracket. You'll hear it click into place, repeat this for each bracket.

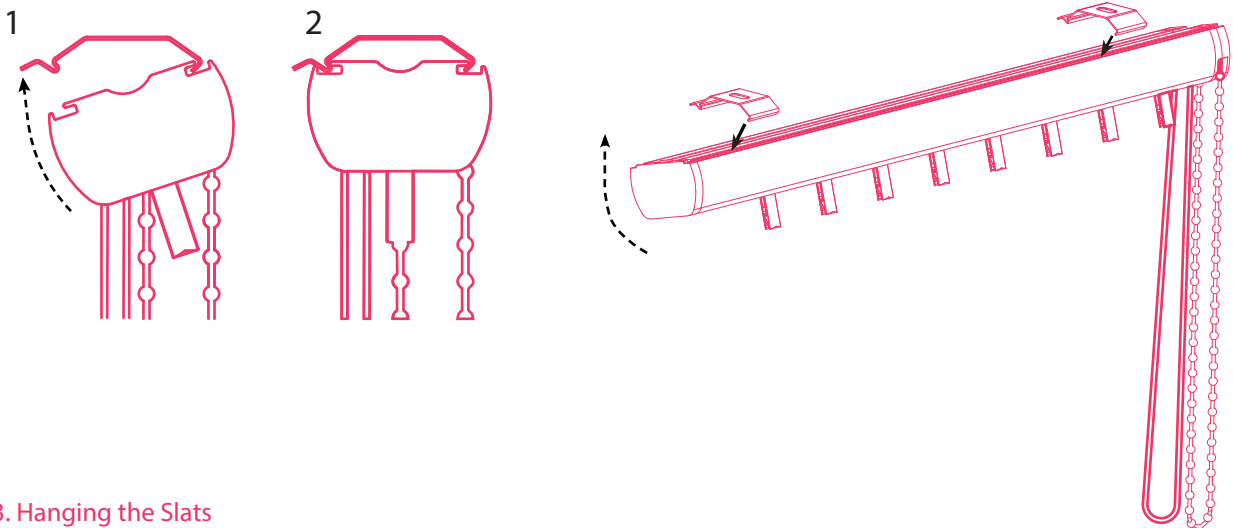

### 3. Hanging the Slats

Follow the slat installation diagram as per below, it'll help to spread the pegs across the vertical blind track. This will help you in having an even work space when installing the slats into the pegs.

**Important:** Do not hang if the hooks are rotated to the flush position to the track, this will cause the slats to not rotate and jam.

If your track has a centre opening and chained weights, open the slats after hanging, then gently partially open the blind and trim the chain in the centre where they are dividing.

#### Slat Installation (Peg Hook)

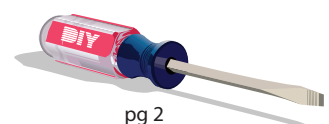
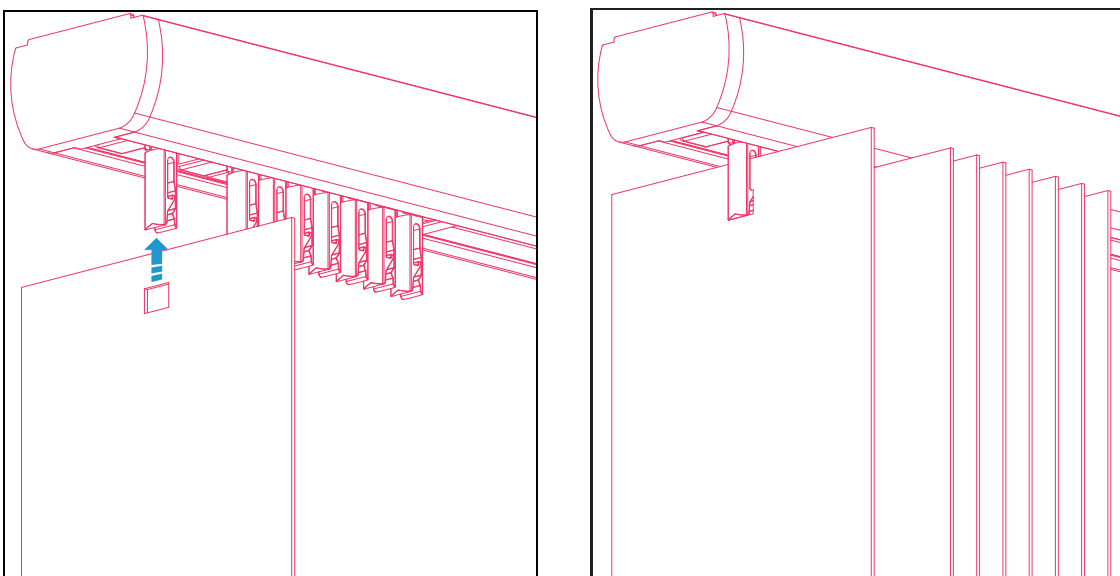

## VERTICAL BLINDS INSTALLATION

### 5. Child Safe Cord Tensioner (P Clip)

Australian Child Safety Laws state that a cord tensioner must be installed if the chain is less than 1.6m from the floor to prevent any risk of strangulation.

- a) Position the tension device at the bottom of the chain loop as shown below. It can be fitted to the inside of the window frame or in front of it.
- b) Install the tension device onto the frame, making sure that the loop chain hangs with minimal tension as illustrated below.

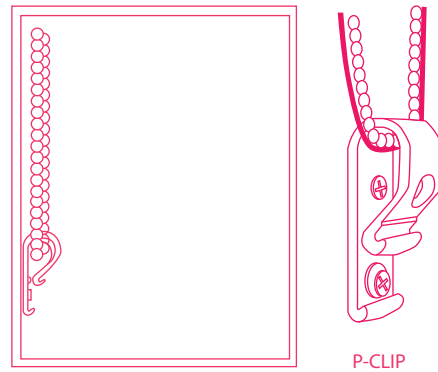

### **WARNING CHILD SAFETY WITH LOOPED CORDS, CHAINS & BEAD CORDS**

Young children can strangle in the loop of pull cords, chain and bead cords, and cords that run through window coverings. They can also wrap cords around their necks. To avoid strangulation, keep cords out of the reach of young children. Also,

1. Install safety devices that remove the cord loop or reduce access to cords, and
2. Move cots and furniture away from window covering cords.

The tension device (P Clip) reduces the hazards of strangulation or entanglement by limited access to the cord or bead chain. Anchor the device with the cord or bead chain to the wall or floor so young children cannot pull the cord or bead chain around their necks. Always keep cords out of the reach of young children.

### Handy Hints & Trouble Shooting

1. If your blind is hard to operate or making clunking noise and not rolling smoothly, it is likely that the positioning of the chain drive end of the blind, is in the incorrect position in the bracket. Please go back to the "Positioning of the Blind" section of the instructions and make sure that the end cap has not been slightly rotated out of position. The ACMEDA logo should always be in the 6 o'clock position.
2. For large blinds, have another person help you hold the blind, whilst placing it into the brackets
3. From time to time a blind can track off to one side, making it hard to wind up and risk the cloth/blind being damaged. This can easily be remedied by unrolling the blind and placing a 10cm piece of masking tape onto the aluminum tube on the side you want the blind to go to. Add a couple more thicknesses until the blind rolls up straight. If this does not fix the problem please contact us.
4. To maintain child safety laws, make sure to attach the P Clip and keep furniture and cots away from blind chains and cords.
5. Cleaning the blind only requires a damp cloth. Make sure not to rub the blind too hard when cleaning as you may damage the block out coating.
6. If the blind has a small curl or kink due to transport, please let the blind settle and this should fall out over time. Warm weather will usually rectify this. Blinds left in one position for long periods of time will result in the fabric holding a memory and forming a curve/kink to the cloth. This will drop out over time. Try to rotate the blind to different heights regularly to avoid this occurring.
7. If you decide that you would like to have the chain control on the opposite side to what you have ordered, simply remove the end caps and swap to opposite sides. You will also need to swap the bracket positions over.



For further information please contact our dedicated customer service team between Monday to Friday 9AM to 9PM or Saturday to Sunday 10AM to 5PM.

**Phone:** 1300 918 390 **Email:** sales@diyonlineblinds.com.au

